

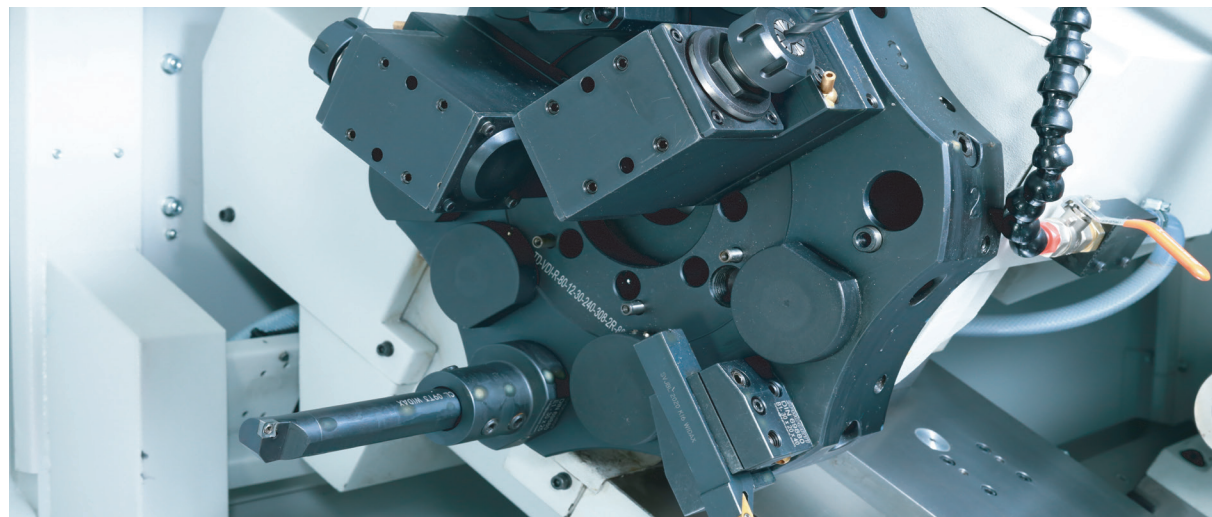

MANUAL TAILSTOCK



**TURN BY WIRE
(HAND WHEEL FUNCTION)**



DTT-80 LIVE TOOL TURRET

STANDARD ACCESSORIES

- 200 X 3 Jaw Manual Chuck with Back Plate
- Driver Plate
- Reduction Sleeve Me50/mt-3
- Coolant System Assembly
- Panel A/C
- Turret Assembly [Btp-80] / Dtt80 - 12 Station (Live Tool)
- Tool Holders (Turning / Boring)
- Dead Centre - Mt-3
- One Set Of service Tools
- Manual Tailstock

OPTIONAL ACCESSORIES

- Quick Clamping Collet Attachment 5c
- Revolving Center
- Axial Live Tool Holder
- Radial Live Tool Holder
- Additional Headstock Side Coolant Provision
- Fixed Steady Rest with Sliding Bolts Dia [10-90mm]
- Fixed Steady Rest with Sliding Bolts Dia (80-160mm)
- Travelling Steady with Sliding Bolts [8-65mm]

**PROTURN 1000
TOOL INTERFERENCE DIAGRAM
(BTP 80 WITH 8 STATION TURRET)**

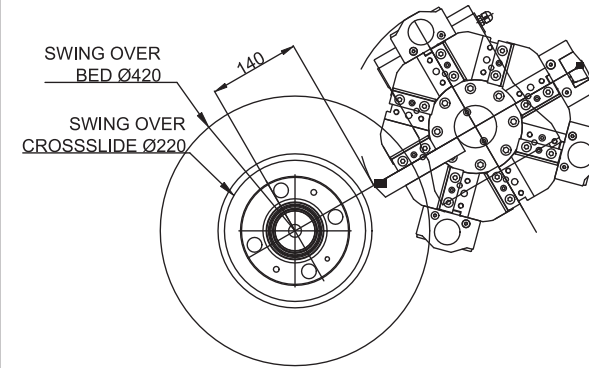

**BTP 80 WITH 8 STATION TURRET
MOUNTED WITH SLOTTED TOOL DISC TD-80-8-25-280**

**PROTURN 1000
TOOL INTERFERENCE DIAGRAM
(DTT 80 WITH 12 STATION-2 PITCH)**

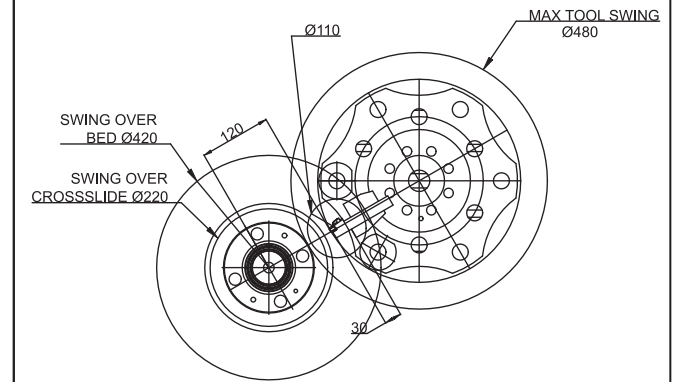

TOOL INTERFERENCE DIAGRAM.
(MAX TURNING Ø240 WHEN TURNING TOOL HOLDER IS MOUNTED ON THE INNER PCD (240mm), MAX TURNING (Ø90) WHEN TURNING TOOL HOLDER MOUNTED ON OUTER PCD (308mm).

DURING FACING MAX DIAMETER SHOULD NOT EXCEED Ø110mm WHEN FACING TOOL HOLDER IS MOUNTED ON INNER PCD 240mm AND TWO ADJACENT HOLDERS ARE EITHER TURNING OR BORING HOLDERS).

PROTURN 1000 WITH DTT TURRET

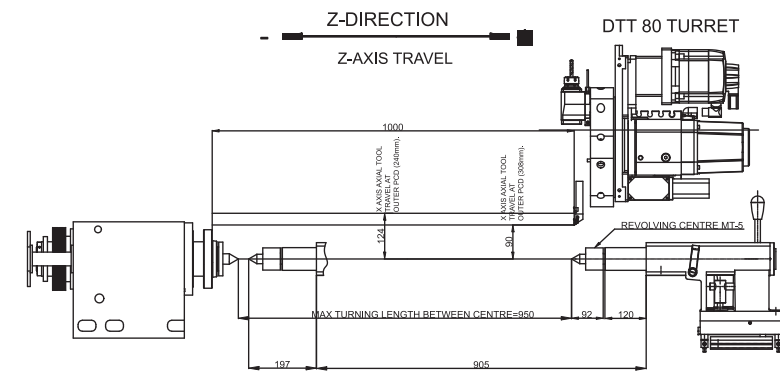

**PROTURN 1000
TOOL INTERFERENCE DIAGRAM
(DTT 80 WITH 12 STATION-2 PITCH)**

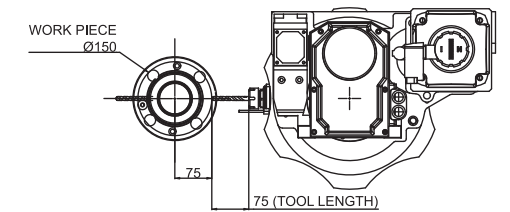

MAX DRILL LENGTH 75mm ON OFFSET RADIAL LIVE TOOL HEAD WHEN JOB DIAMETER(Ø150mm) FOR RADIAL DRILLING WHEN USING OFFSET RADIAL TOOL HOLDER.

PROTURN 1000 WITH BTP 80 TURRET

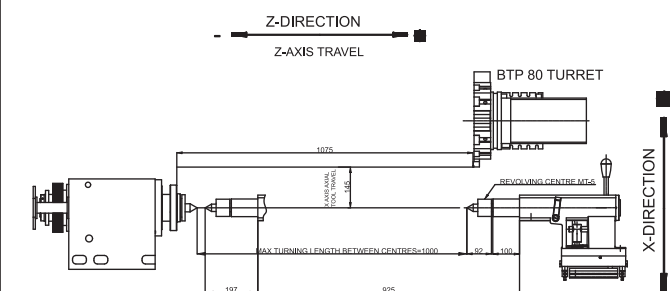

Note: Please consult us with component drawings, operations required for selection of suitable specification and features.